

static seal R12-F

seal spec

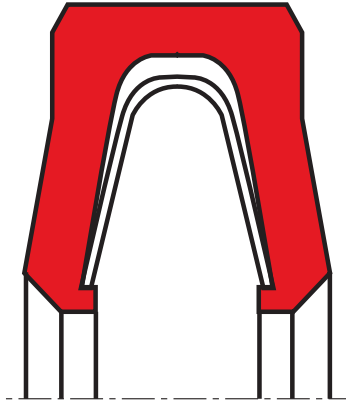

description

fingerspring activated flange seal, excellent chemical and thermal resistance, mainly used on flanges, fittings or pivoting joints in chemical industry.

application



category of profile

machined only.

single acting PTFE flange seal

operating parameters & materials

diameter range: up to 600 mm

material		temperature	max. Speed	max. pressure ¹
sealing element	spring			
s-mart PTFE glass	14.310	-200 °C ... +260 °C	15 m/s	300 bar (30 MPa)
s-mart PTFE bronze	14.310	-200 °C ... +260 °C	15 m/s	300 bar (30 MPa)
s-mart PTFE carbon	14.310	-200 °C ... +260 °C	15 m/s	300 bar (30 MPa)

the stated operation conditions represent general indications. it is recommended not to use all maximum values simultaneously.

surface speed limits apply only to the presence of adequate lubrication film.

¹ pressure ratings are dependent on the size of the extrusion gap.

L [mm]	spring
3 ... 4,6	6,35 x 0,15
> 4,6 ... 6	9,8 x 0,18
> 6 ... 8	14,1 x 0,22

surface quality

surface roughness	static		rotating	
	Rtmax (µm)	Ra (µm)	Rtmax (µm)	Ra (µm)
sea surface	≤ 1,2 - 2,4	≤ 0,3 - 0,5	≤ 0,4 - 0,8	≤ 0,1 - 0,2
groove face	≤ 6,3 - 10	≤ 0,8 - 2,2	≤ 6,3 - 10	≤ 0,8 - 2,2

**tolerance recommendation****seal housing tolerances**

L	+L 0,022
Ød	-0,2
ØD	H10

seal & housing recommendations

please note that we are able to produce those profiles to your specific need or any non standard housing. for detail measurements, please see seal-mart catalog...

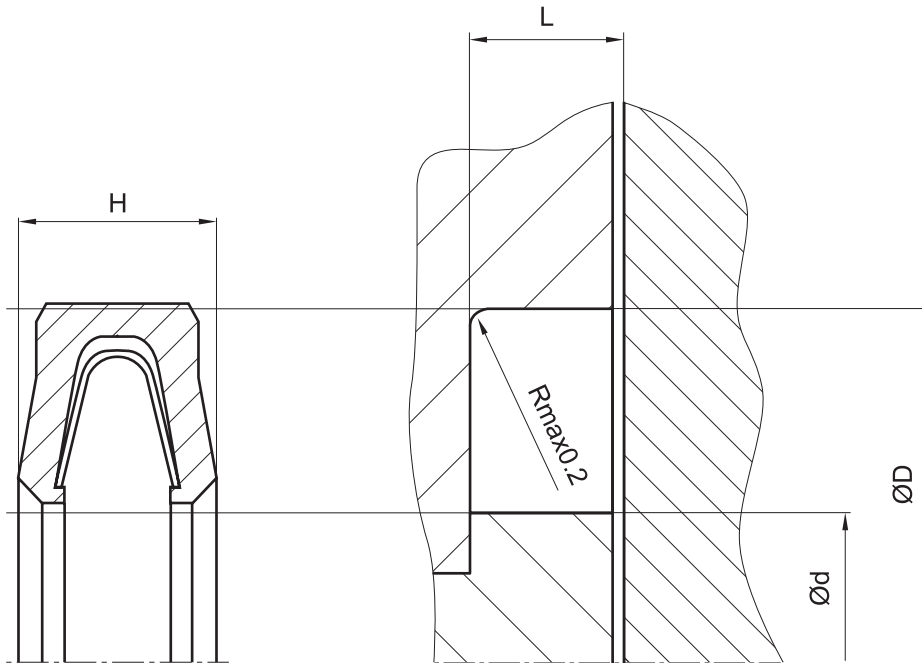

don't hesitate to contact our technical department for further information or for special requirements (temperature, speed etc.), so that suitable materials and/or designs can be recommended.